

CC025 Installation Instruction

Please be sure to use a manual screwdriver and refrain from using an electric drill.



The installation is complete

CAUTION

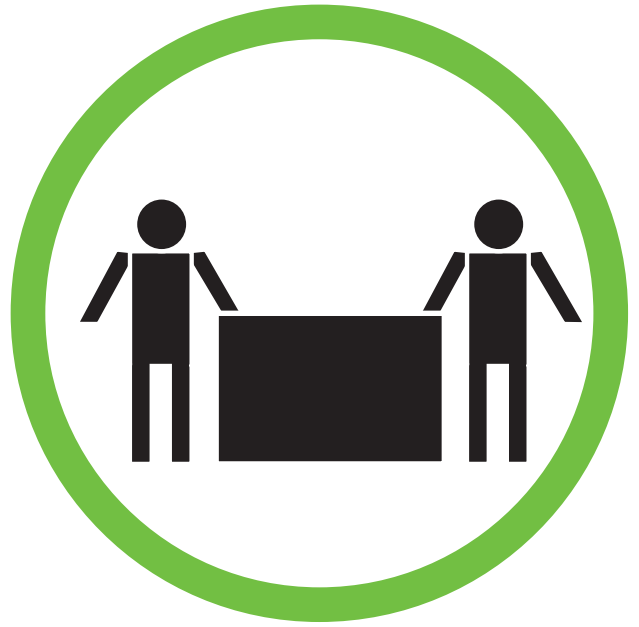

TWO PERSONS LIFT & INSTALLATION

Important: This product is oversized and heavy. For safe assembly and to avoid damage, at least two people are required. When flipping or moving the item, always lift carefully. Never drag, drop, or handle it roughly.



cabinet door hinges



handle



self tapping



nail



black screw



Clothes pole holder

Hand screw



Clothes rail



screwdriver



Lock



Bai Zi

Hardware Accessories





Install black screws on the white plate



Install black screws on the white plate

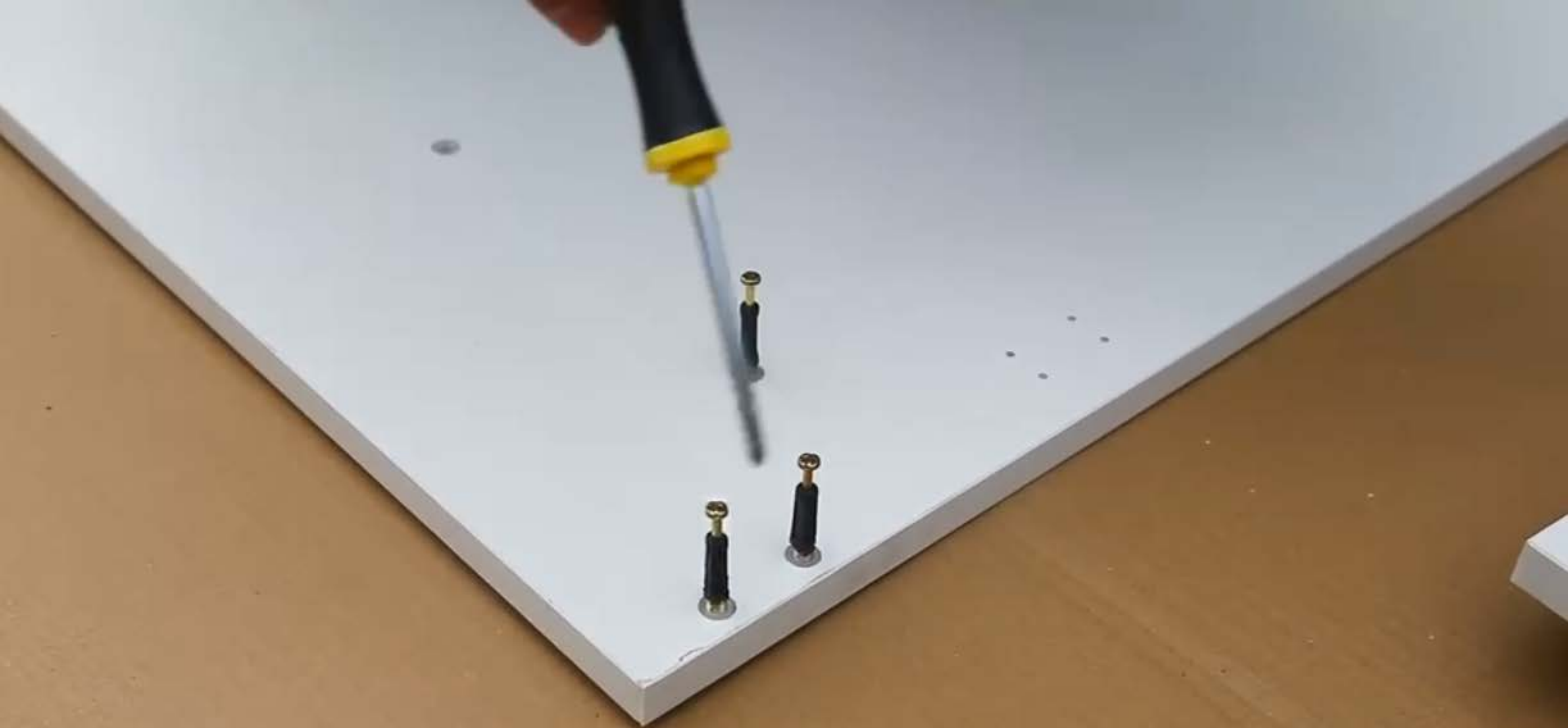

Install black screws on the white plate



Black screws need to be installed on the front and back sides of the base plate, large shelves, and middle partitions.



Black screws need to be installed on the front and back sides of the base plate, large shelves, and middle partitions.



Black screws need to be installed on the front and back sides of the base plate, large shelves, and middle partitions.



Black screws need to be installed on the front and back sides of the base plate, large shelves, and middle partitions.

Seek



Black screws need to be installed on the front and back sides of the base plate, large shelves, and middle partitions.





Install the connection between large shelves and back slats



Install the connection between large shelves and back slats



Install the connection between large shelves and back slats



Install vertical partitions



Install the connection between large shelves and back slats



Install vertical partitions



Install vertical partitions



Install large shelves



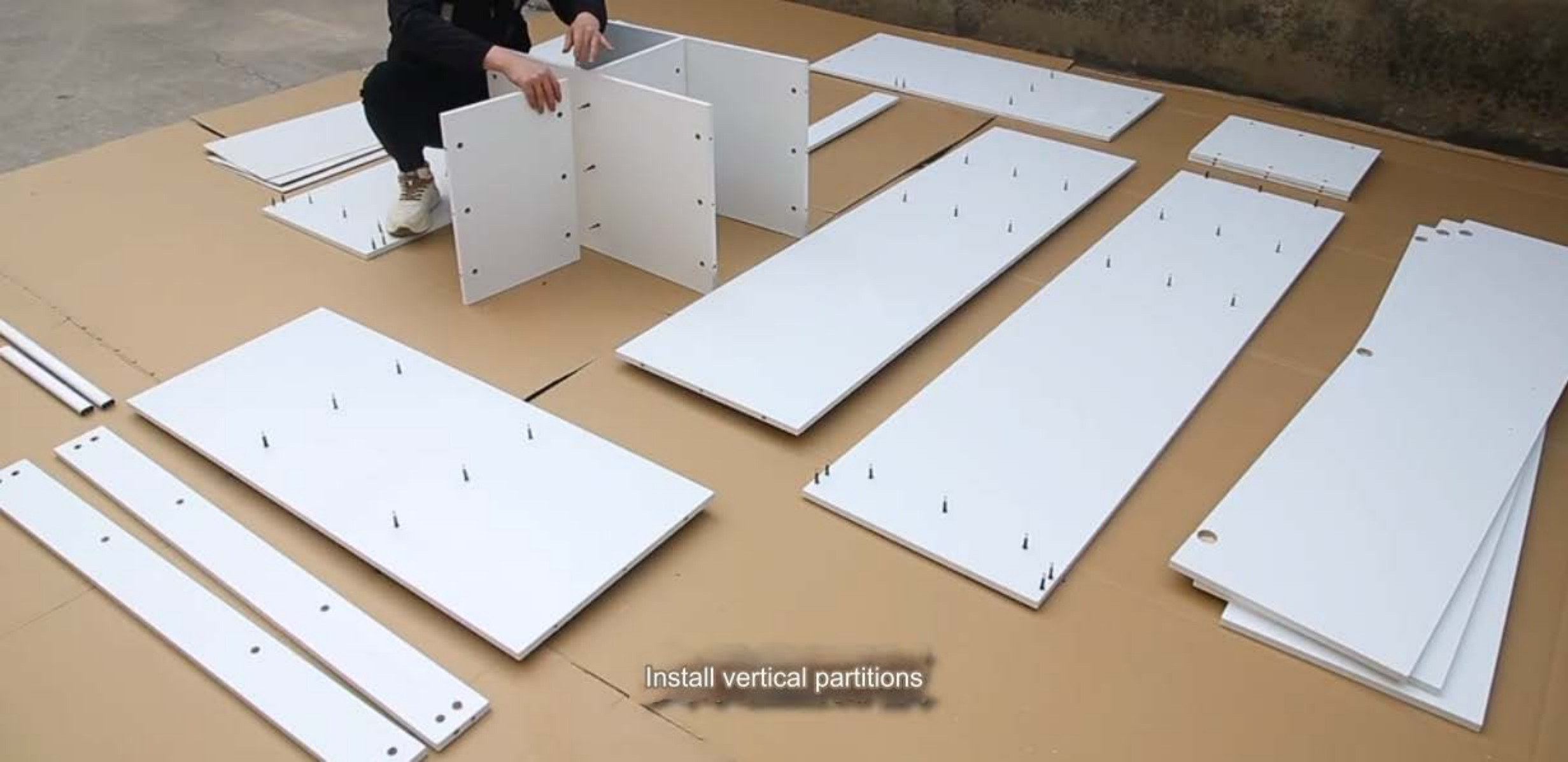

Install vertical partitions



Install the middle partition



Install the middle partition



Install the middle partition





Install base plate



Install base plate



Install two baseboards



Install two baseboards



Install two baseboards



Install two baseboards







Install two small shelves



Install two small shelves



Install two small shelves



Install top plate



Install left side panel



Install left side panel



Install the right side panel





Tighten all locks to secure the cabinet



Tighten all locks to secure the cabinet

A close-up photograph showing a person's hand, wearing a black sleeve, using a small metal tool to tighten a lock on the corner of a white cabinet. The cabinet is composed of several white panels meeting at a corner. The background is a plain, light-colored wall. The text "Tighten all locks to secure the cabinet" is overlaid at the bottom of the image.

Tighten all locks to secure the cabinet



Tighten all locks to secure the cabinet



Tighten all locks to secure

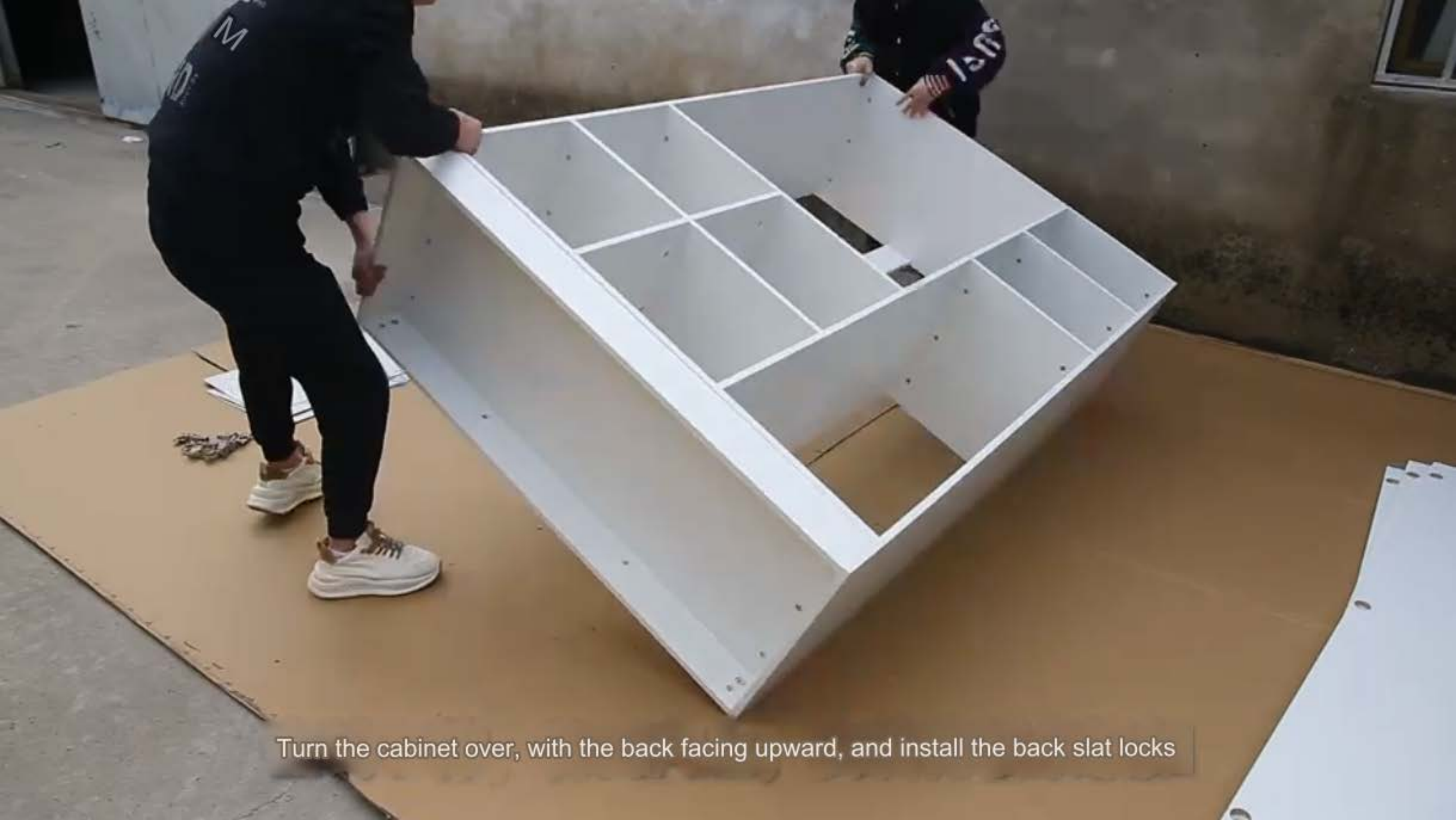

Turn the cabinet over, with the back facing upward, and install the back slat locks

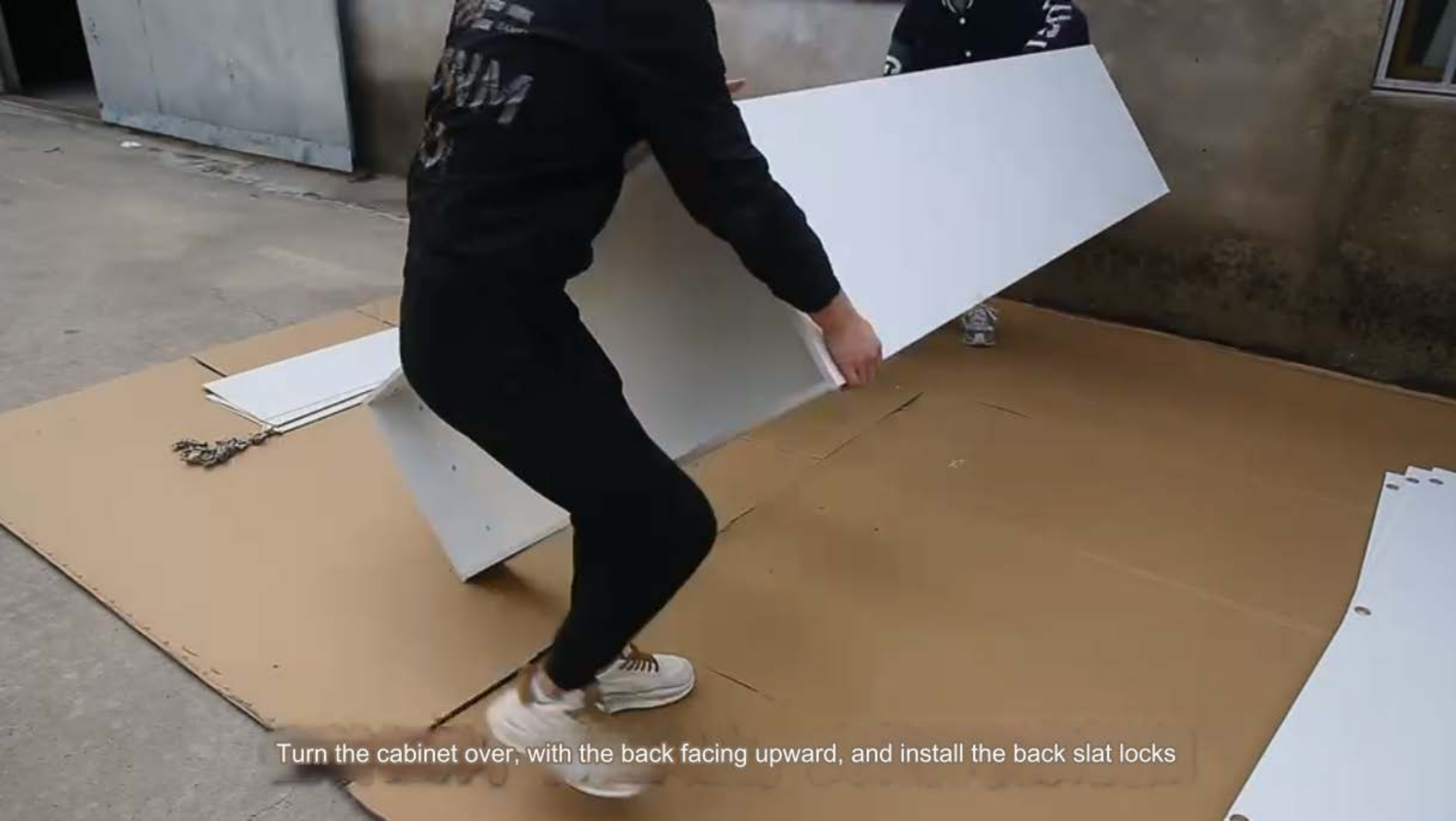

Turn the cabinet over, with the back facing upward, and install the back slat locks



Turn the cabinet over, with the back facing upward, and install the back slat locks



Place the back plate and align the back plate with the top plate



Place the back plate and align the back plate with the top plate

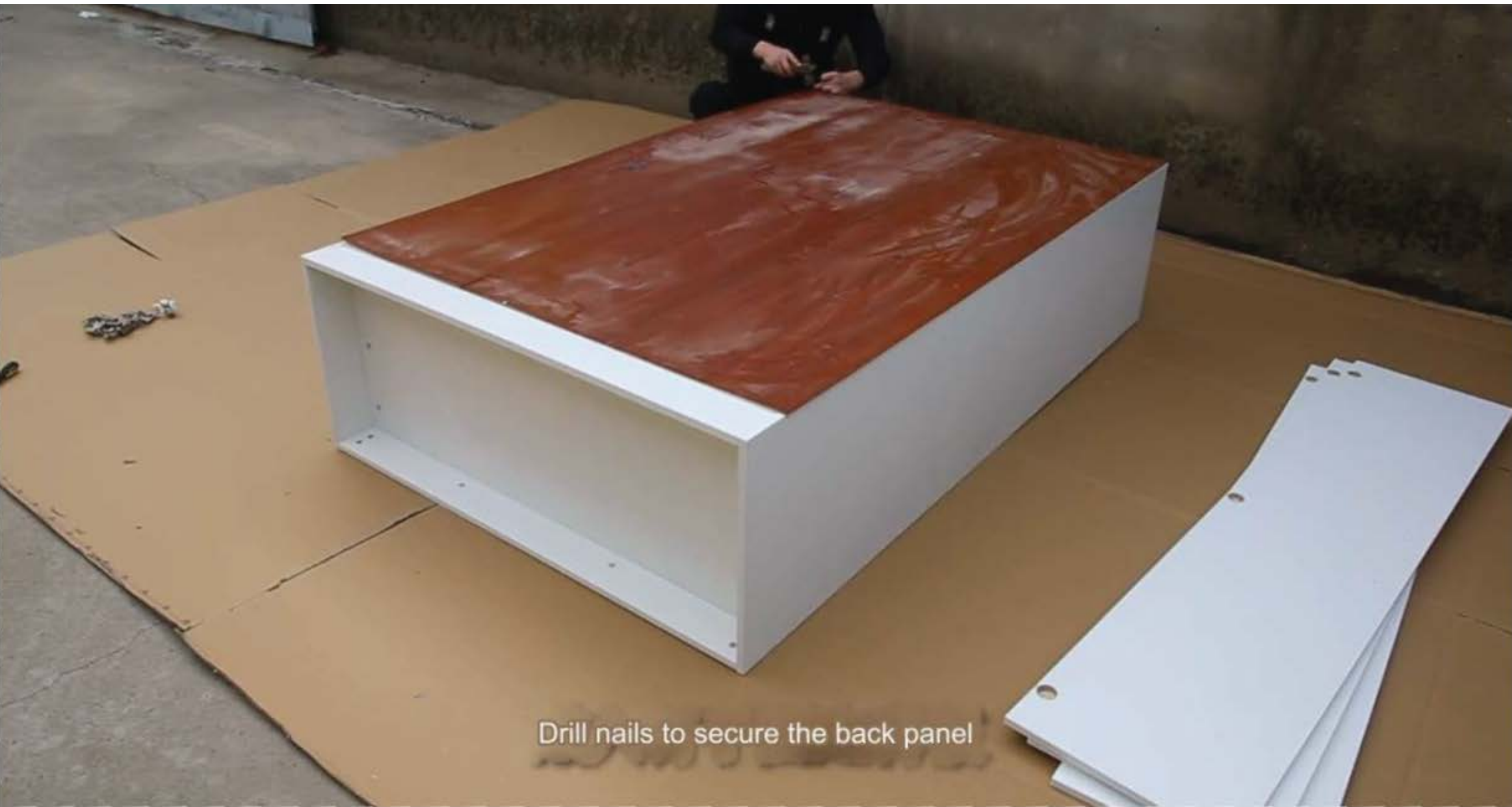

Drill nails to secure the back panel



Drill nails to secure the back panel



Drill nails to secure the back panel



Turn the cabinet over, right side up



Install cabinet door hinges and use self-tapping screws to fix them



Install cabinet door hinges and use self-tapping screws to fix them



Install cabinet door hinges and use self-tapping screws to fix them



Install cabinet door hinges and use self-tapping screws to fix them



Install cabinet door hinges and use self-tapping screws to fix them



Install cabinet door hinges and use self-tapping screws to fix them



Install the cabinet door on the left and right side panels and the middle partition, and use self-tapping threads to fix the cabinet door hinges



Install the cabinet door on the left and right side panels and the middle partition, and use self-tapping threads to fix the cabinet door hinges



Install the cabinet door on the left and right side panels and the middle partition, and use self-tapping threads to fix the cabinet door hinges



Install the cabinet door on the left and right side panels and the middle partition, and use self-tapping threads to fix the cabinet door hinges



Install the cabinet door on the left and right side panels and the middle partition, and use self-tapping threads to fix the cabinet door hinges



Install the cabinet door handle and fix it with handle screws



Install the cabinet door handle and fix it with handle screws



Install the cabinet door handle and fix it with handle screws



Install the cabinet door handle and fix it with handle screws



When the cabinet doors are uneven, please adjust the two screws on the hinges.



When the cabinet doors are uneven, please adjust the two screws on the hinges.



When the cabinet doors are uneven, please adjust the two screws on the hinges.



When the cabinet doors are uneven, please adjust the two screws on the hinges.



Install top plate



Install the clothes rail support in the middle position, about 8 cm from the top, and use self-tapping screws to fix it



Install the clothes rail support in the middle position, about 8 cm from the top, and use self-tapping screws to fix it

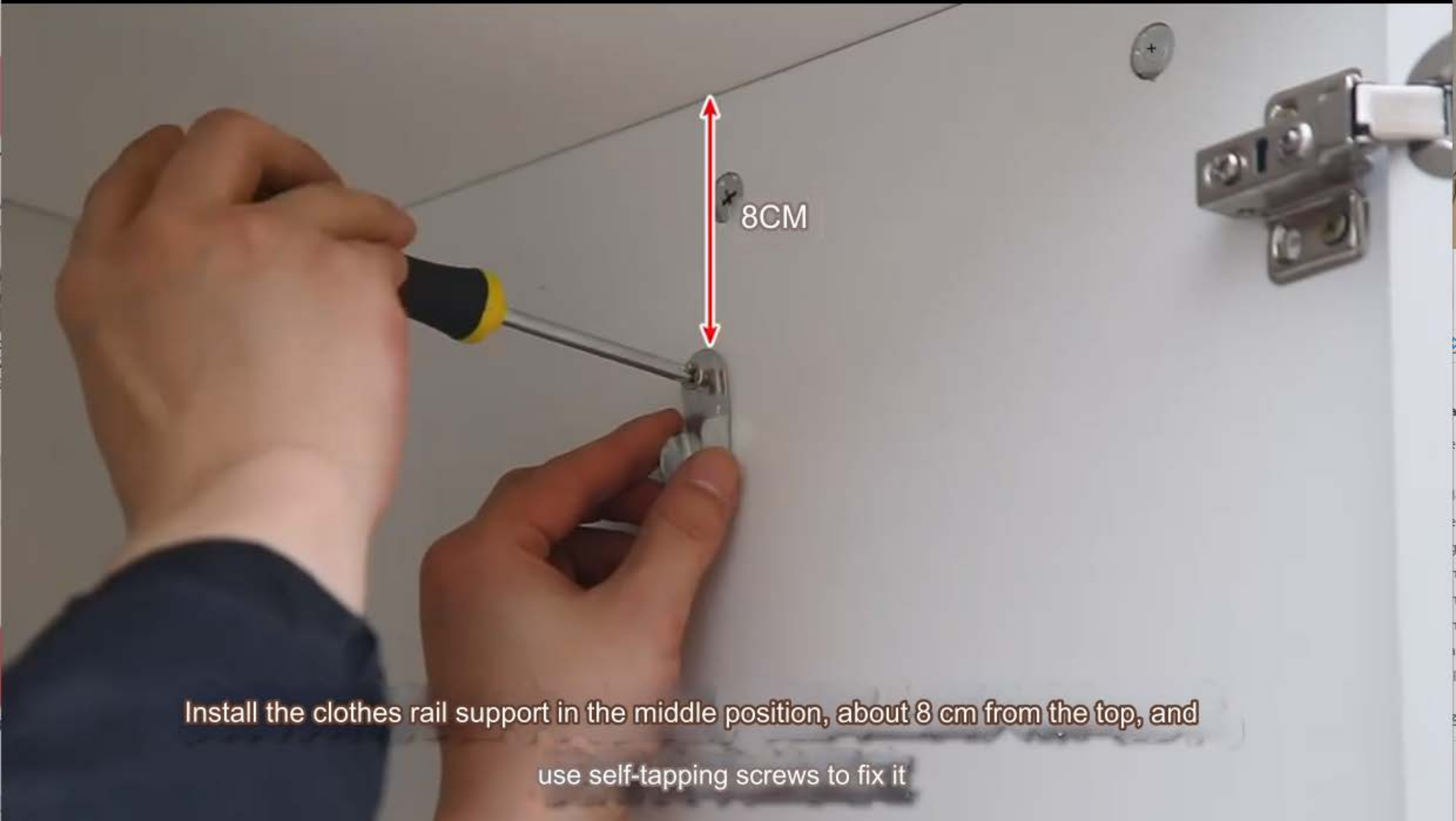

Install the clothes rail support in the middle position, about 8 cm from the top, and use self-tapping screws to fix it



Install the clothes rail support in the middle position, about 8 cm from the top, and use self-tapping screws to fix it



Put up a clothes rail



Put up a clothes rail