

# DR024 ASSEMBLY INSTRUCTIONS

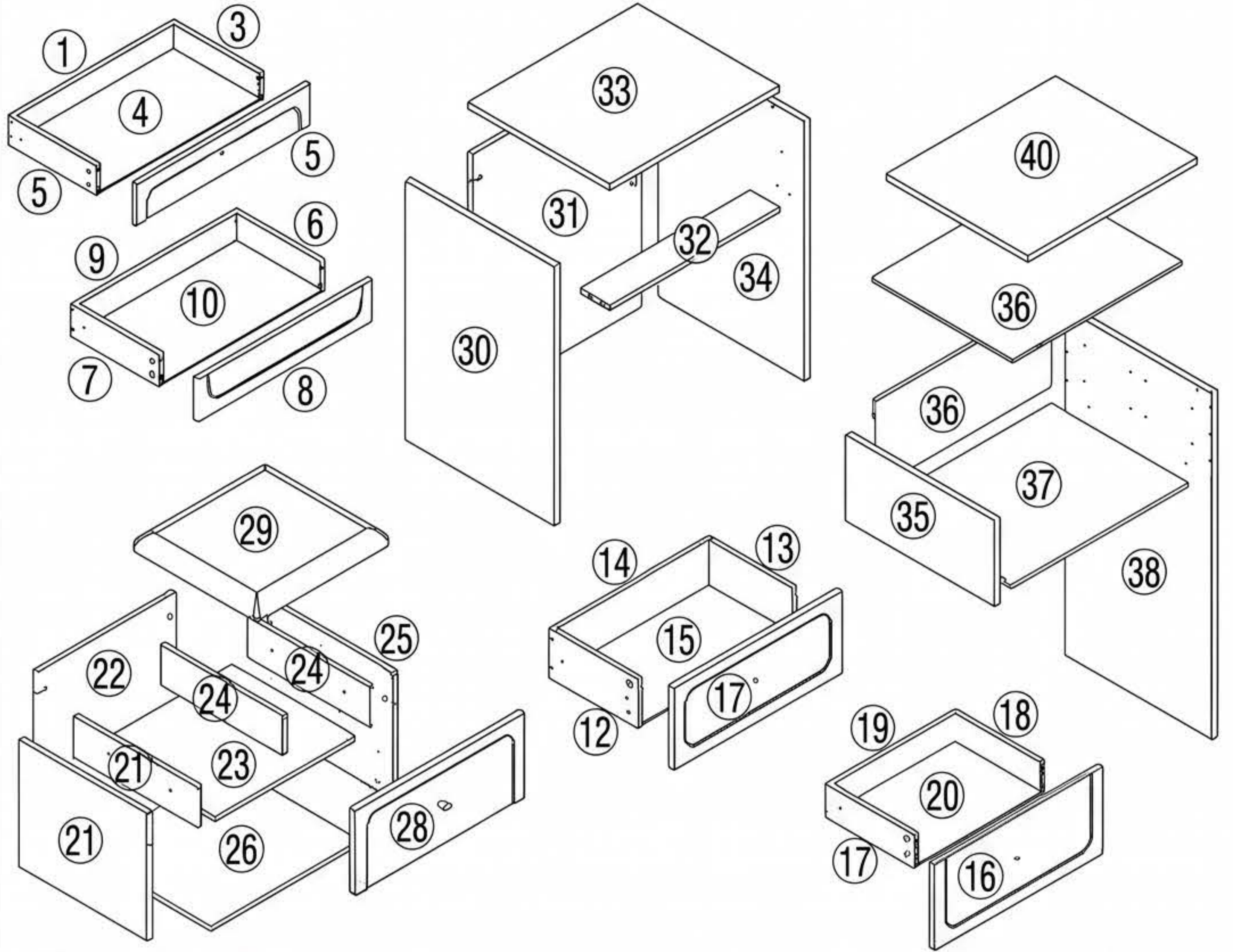
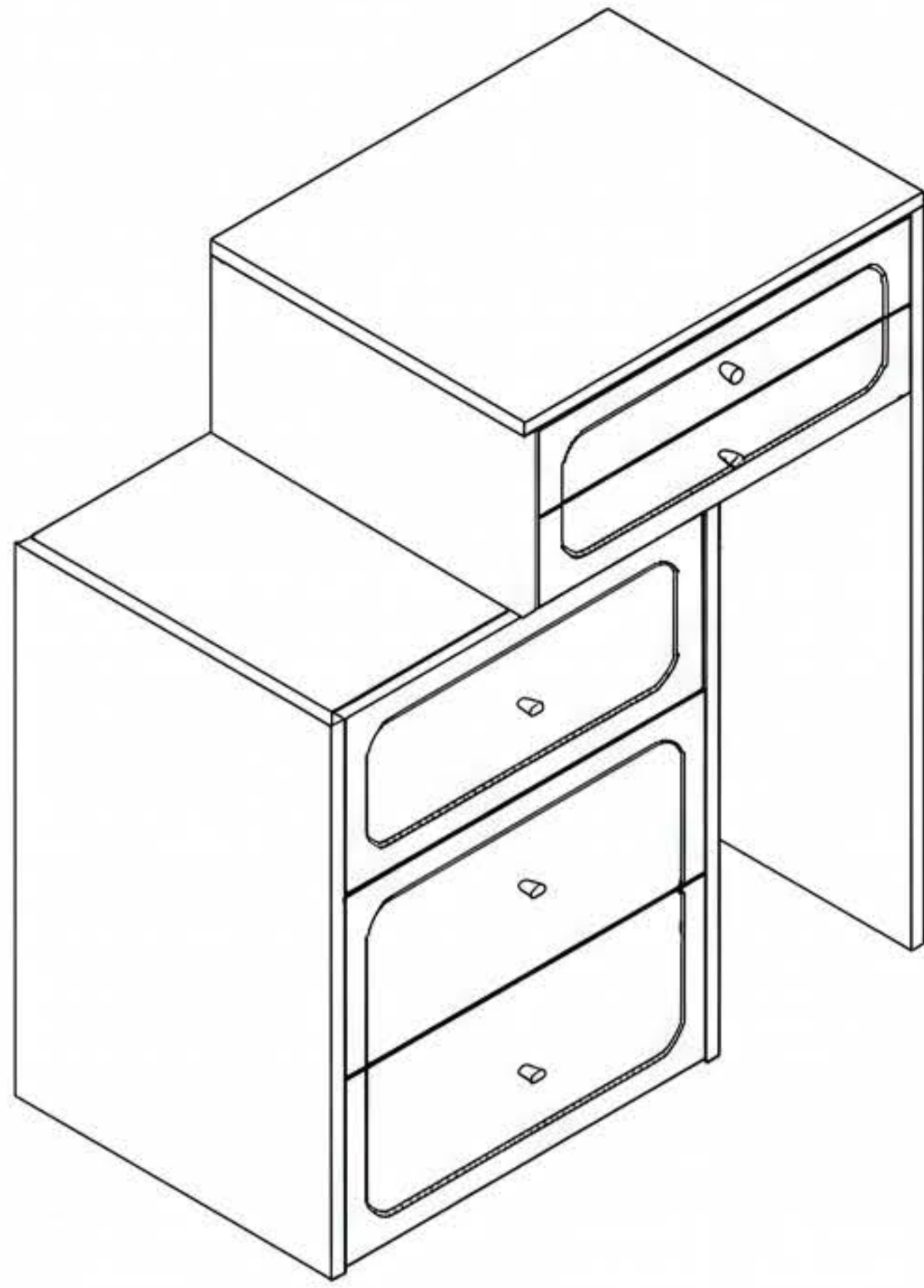

① Upper Drawer Front 1 pcs	⑥ Upper Drawer Front 1 pcs	⑫ Lower Right Drawer Side 1 pcs	⑮ Vanity Drawer Front 1 pcs	⑮ Vanity Stool Drawer Front 1 pcs	⑳ Stool Drawer Back 1 pcs	⑳ Side Cabinet Left Side Panel 1 pcs
② Upper Left Drawer Side 1 pcs	⑦ Lower Left Drawer Side 1 pcs	⑫ Lower Left Drawer Side 1 pcs	⑰ Vanity Drawer Praver 1 pcs	⑱ Stool Drawer Bottom 1 pcs	㉑ Stool Drawer Right Side 1 pcs	㉑ Side Cabinet Back Panel 1 pcs
③ Upper Right Drawer Side 1 pcs	⑧ Lower Right Drawer Side 1 pcs	⑬ Stool Drawer Right Side 1 pcs	⑱ Stool Drawer Right Side 1 pcs	⑲ Stool Drawer Back 1 pcs	㉒ Stool Drawer Panel 1 pcs	㉒ Side Cabinet Bottom Panel 1 pcs
④ Upper Drawer Back 1 pcs	⑨ Lower Drawer Bottom 1 pcs	⑭ Stool Back Panel 1 pcs	㉓ Stool Shelf 1 pcs	㉕ Stool Top/Seat 1 pcs	㉕ Stool Side Connector 1 pcs	㉕ Side Cabinet Right Side Panel 1 pcs
⑤ Upper Drawer Bottom 1 pcs	⑩ Lower Drawer Bottom 1 pcs	⑮ Stool Support Panel 1 pcs	㉑ Stool Back Panel 1 pcs	㉗ Stool Front Brace 1 pcs	㉘ Stool Door 1 pcs	㉙ Top Panel 1 pcs
⑥ Top Panel 1 pcs	⑪ Medium Cabinet, Drawer Front Panel 1 pcs	⑬ Medium Cabinet, Left Panel 1 pcs	㉑ Stool Shelf 1 pcs	㉘ Stool Door 1 pcs	㉙ Top Panel 1 pcs	④⑩ Mirror Frame 1 pcs

PART	A	B	C	D	E	F	G	H	I	J	K	L	M
NAME	Cam Lock & Connecting Bolt Set	Wood Screw	Wood Screw	Wood Screw	Protection Screw	Handle	Wood Dowel	Cabinet Hinge	Drawer Slide	Shelf Pin	Caster Wheel	Expansion Tube	Hole Plug
DIAGRAM													
SPECIFICATION	G12/L-40	03.5x45	03.5x16	03.5x15	64x16		66x40	Plain Hinge	10 Inch Slide				
QUANTITY	62	18	5	70	6	5	7	2	1	4	4	10	8

## CAM LOCK INSTALLATION INSTRUCTIONS

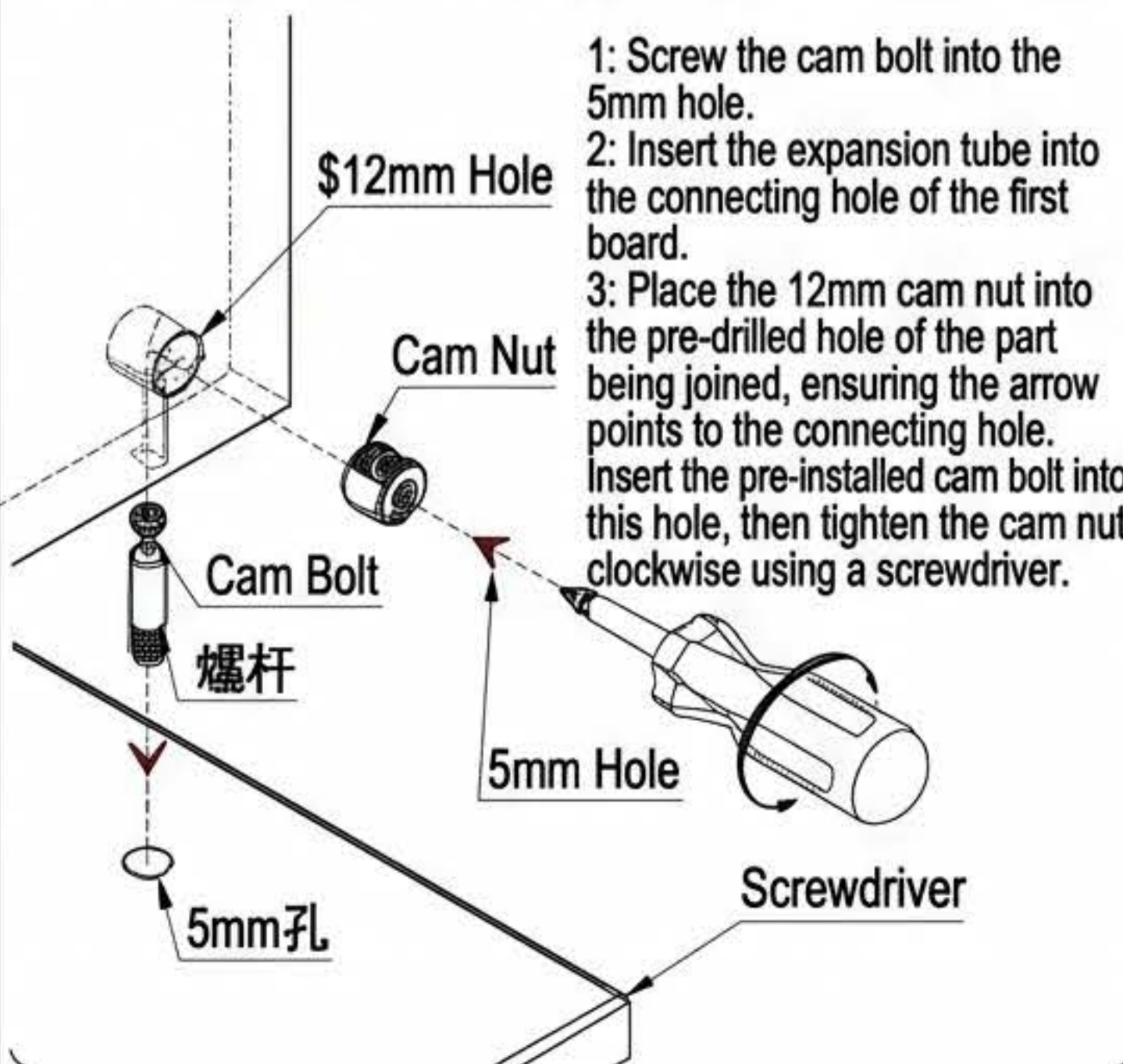

## CASTER WHEEL INSTALLATION

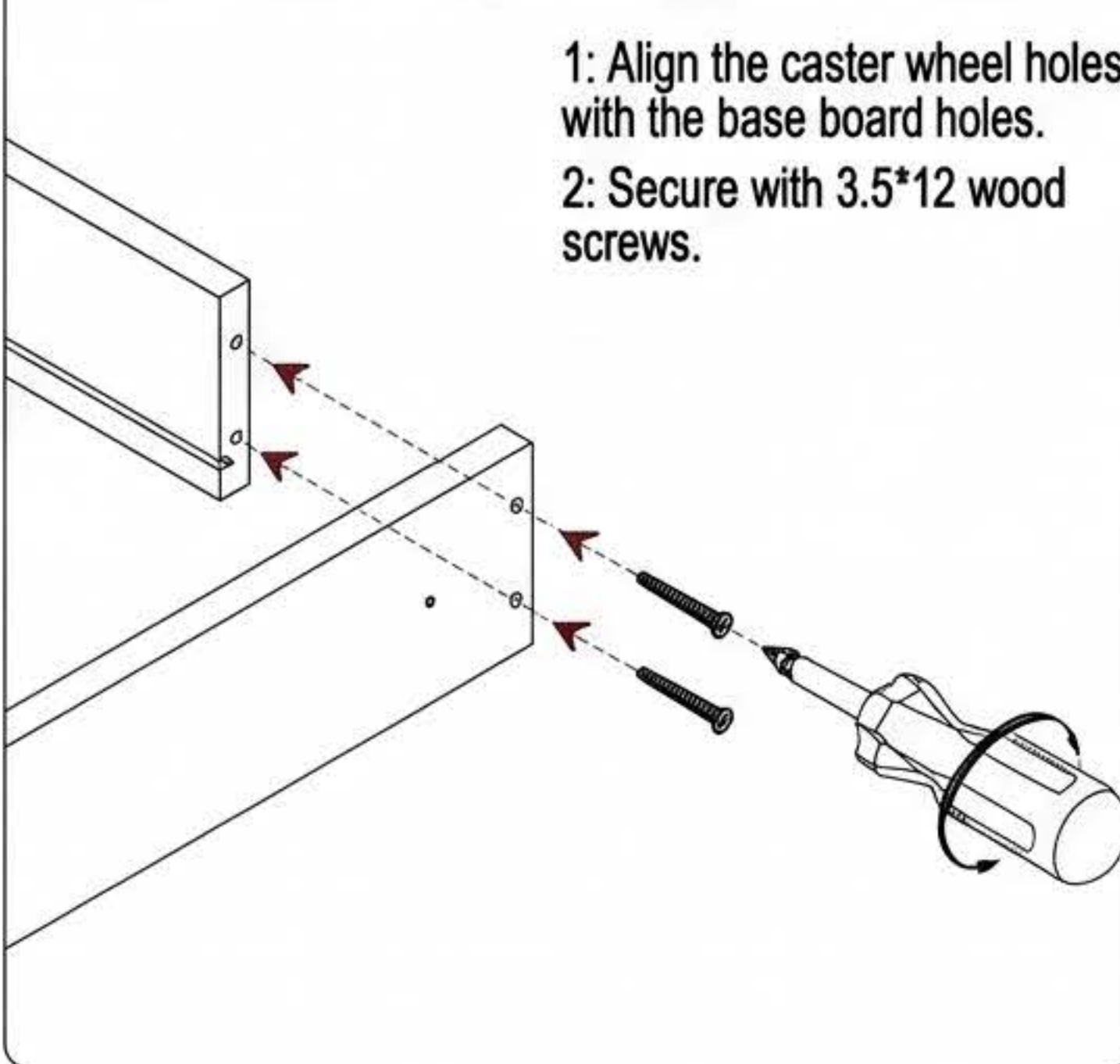

## DRAWER SLIDE INSTALLATION

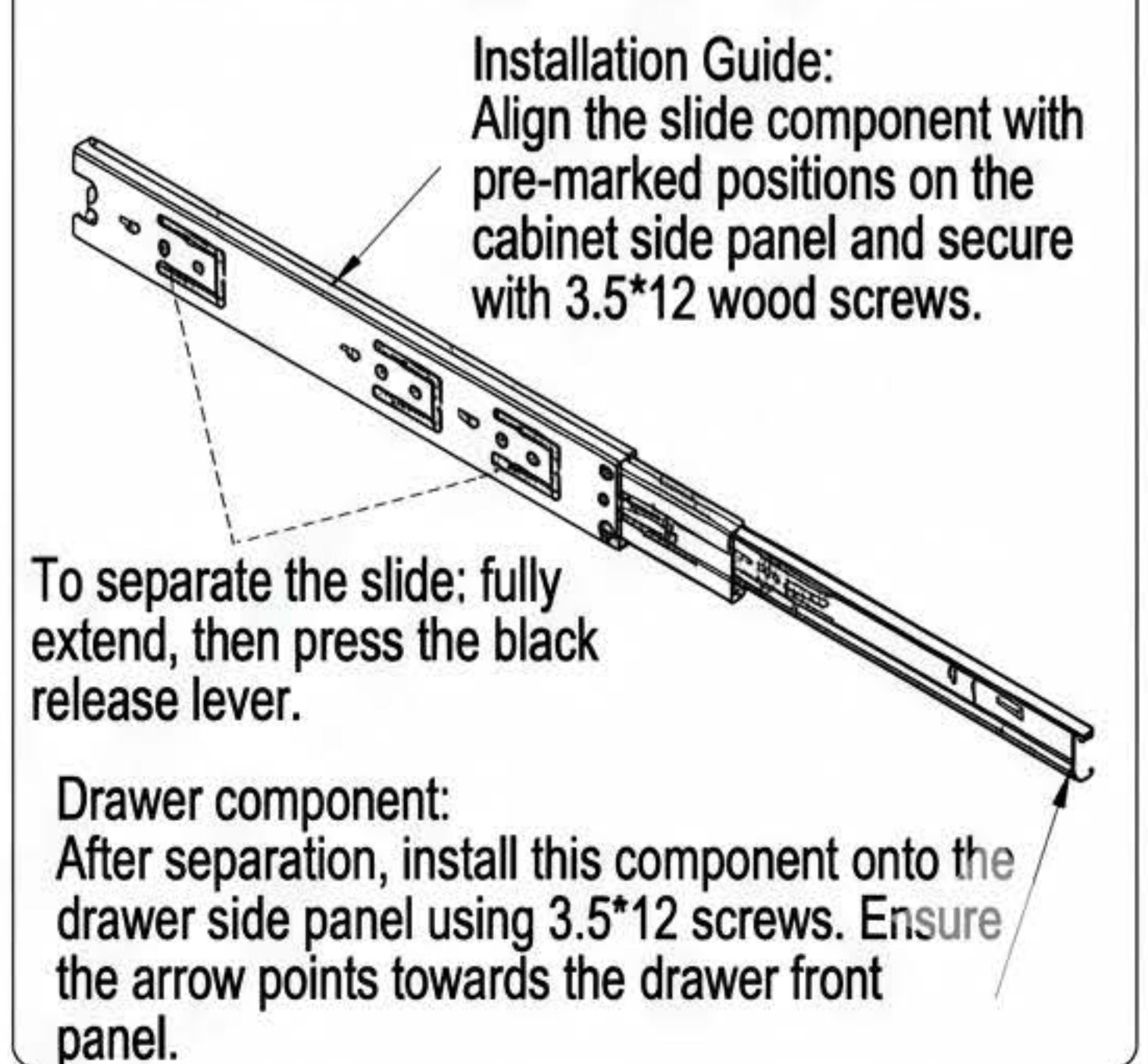

Step 1: Locate panels 1 through 10, and assemble them to form the two drawers shown below.

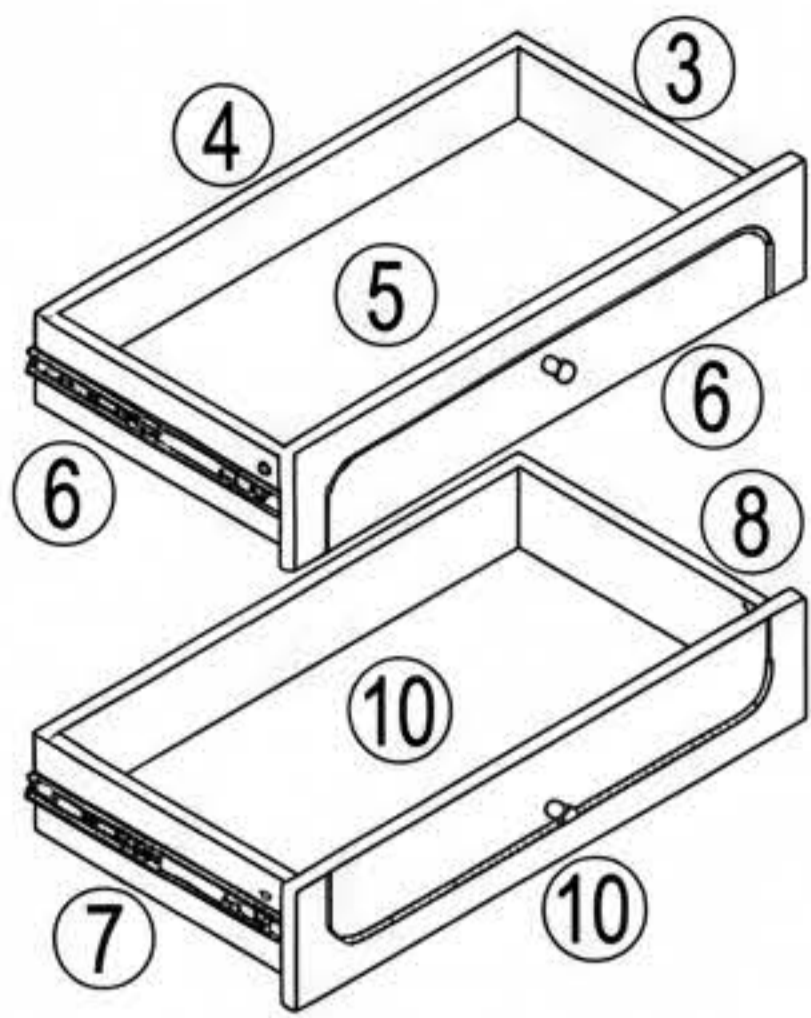

Step 2: Locate panels 11 through 20 and assemble into the two drawers illustrated below.

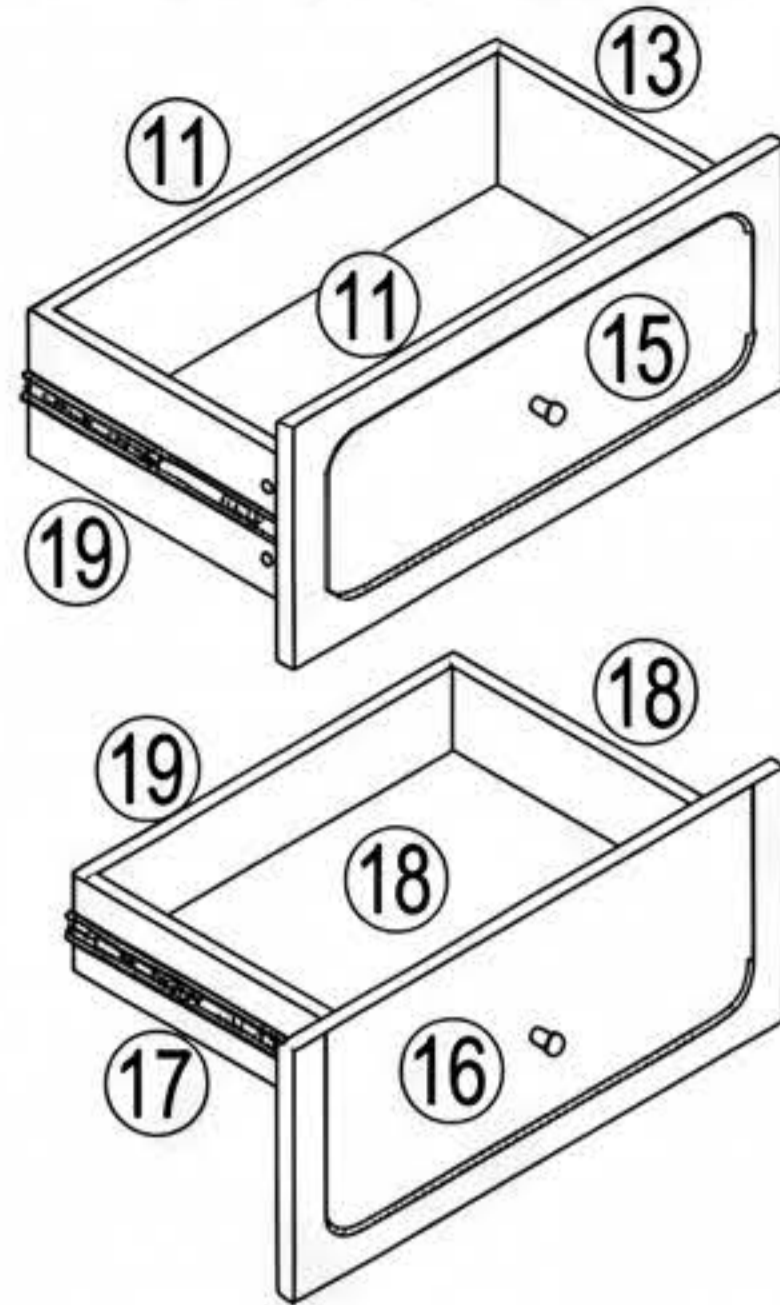

Step 3: Locate panels 21, 22, 23, 24, 25, 26 and assemble as shown in the diagram.

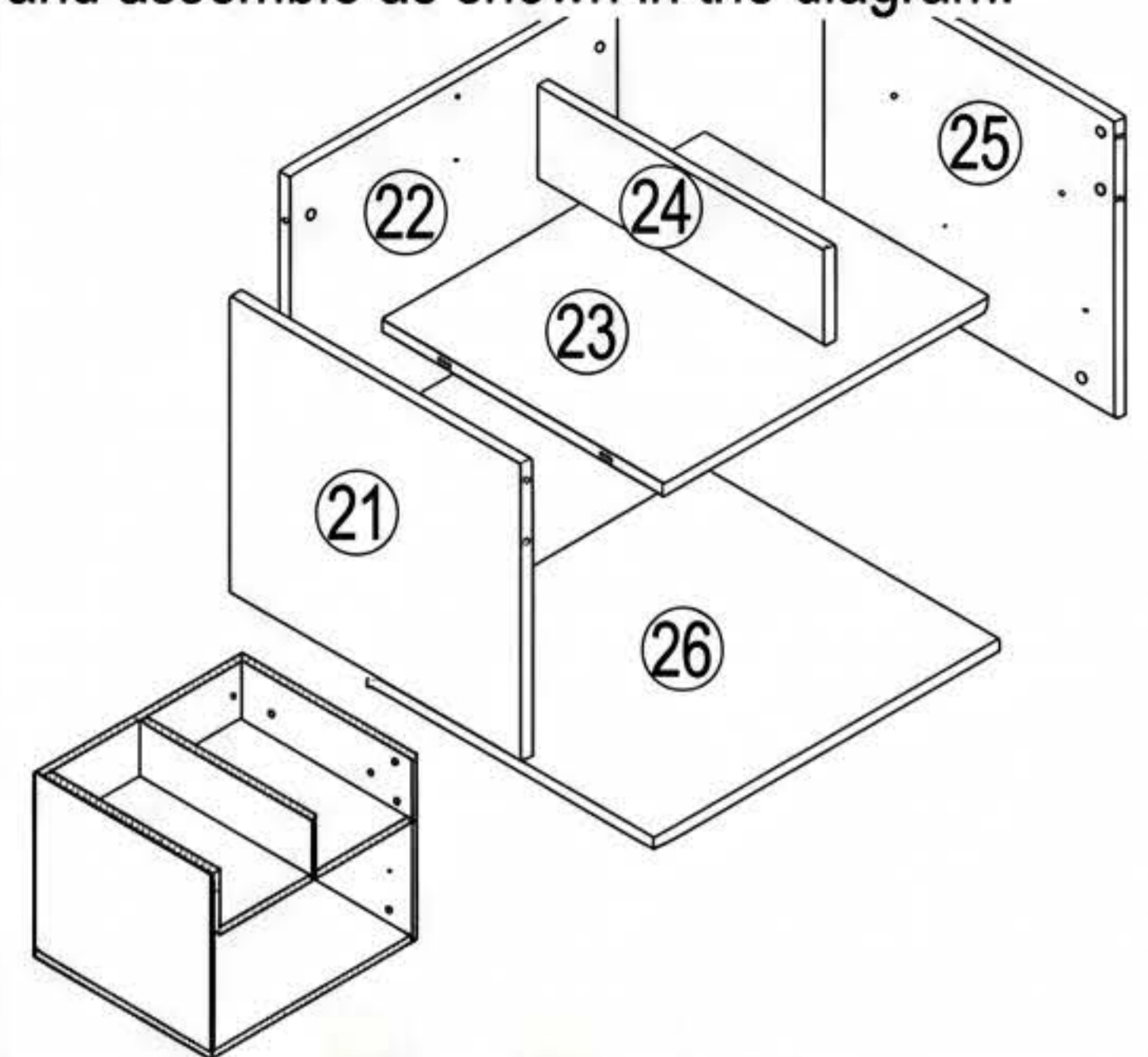

Step 4: Locate panels 27, 28, 29 and the four castors, and assemble as shown below.

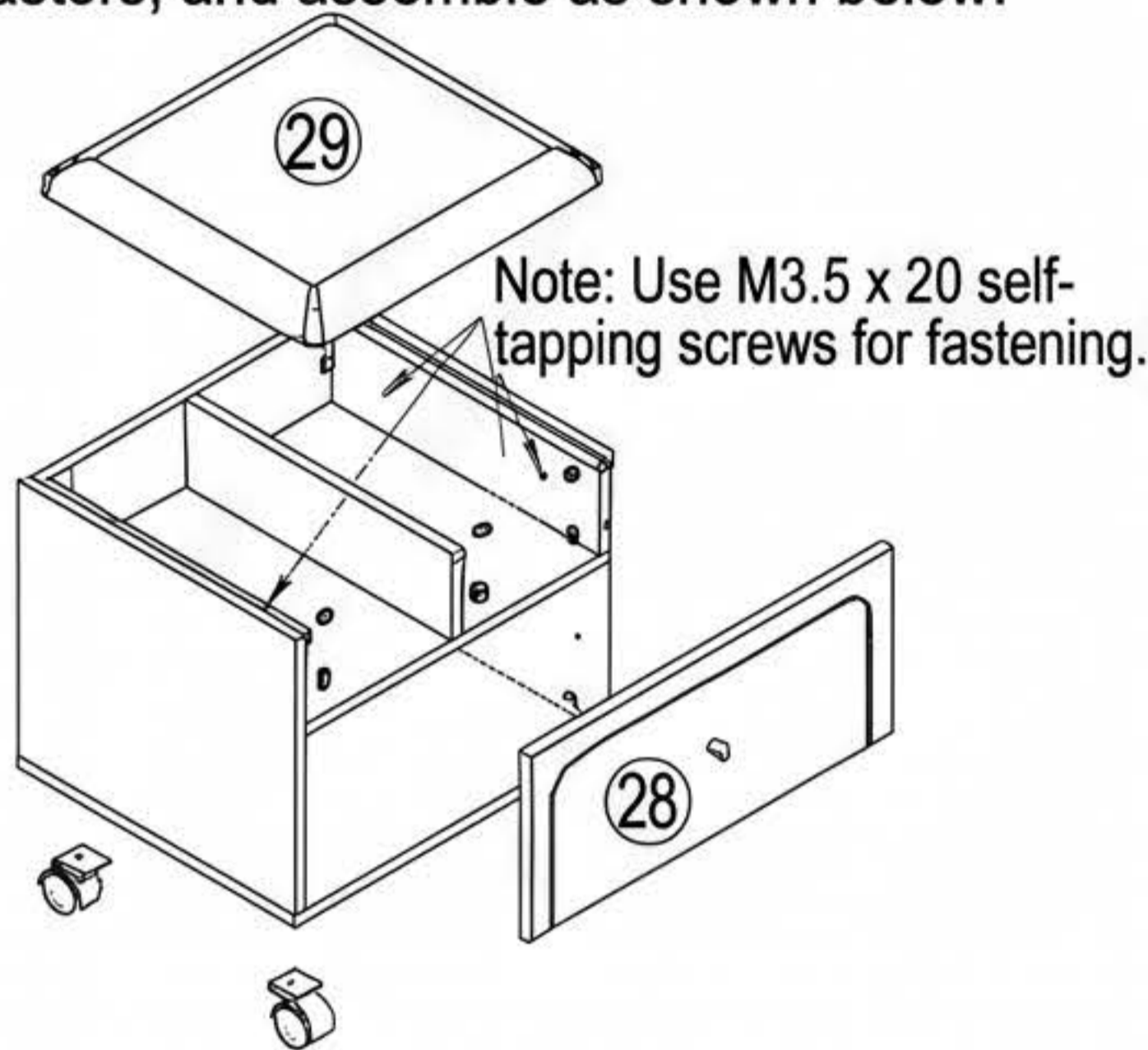

Step 5: Locate panels 30, 31, 32, 33, 34 and assemble as shown below.

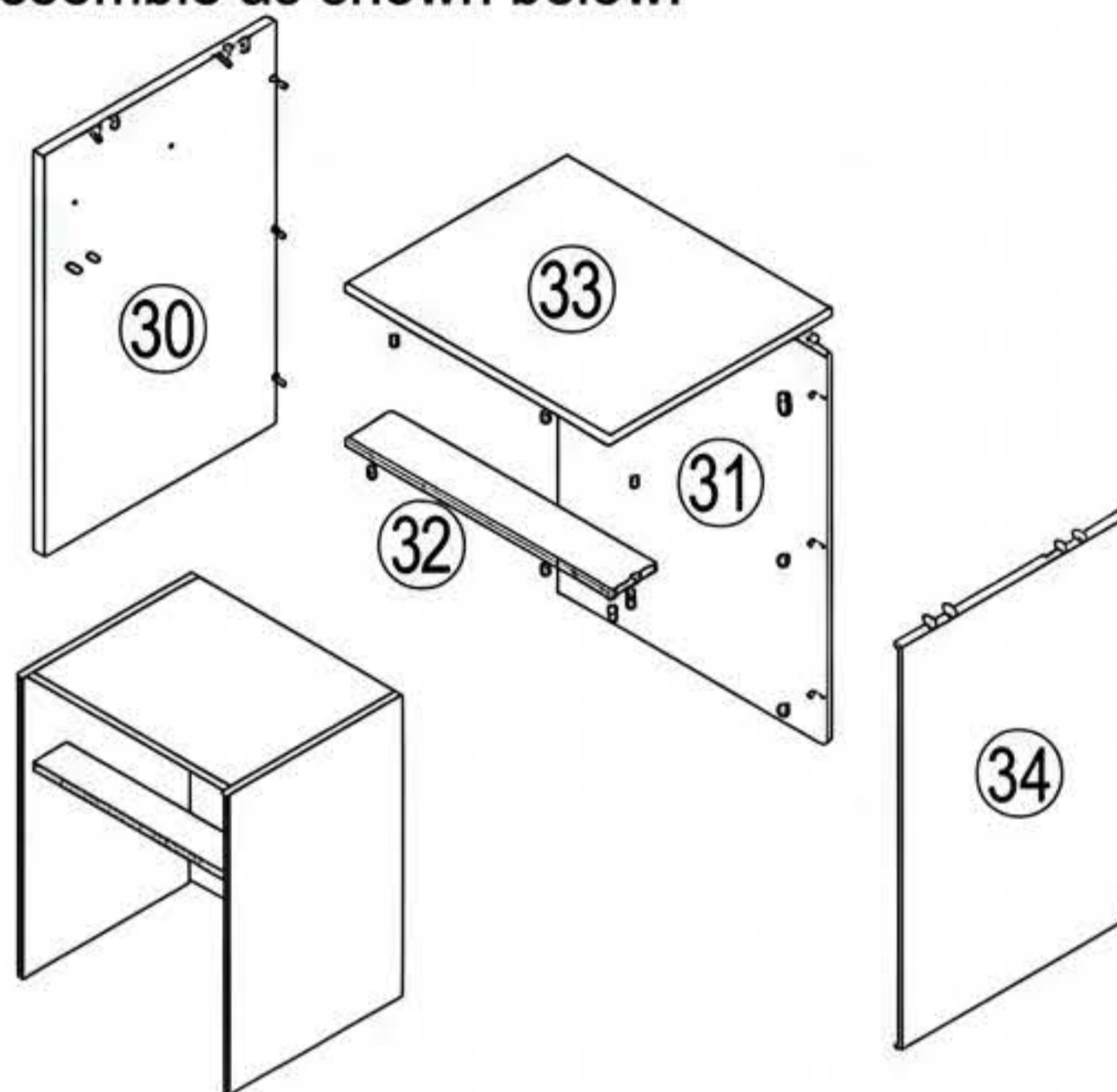

Step 6: Install the two drawers from Step 1 using the pre-installed drawer slides. Align at the connection points as shown.

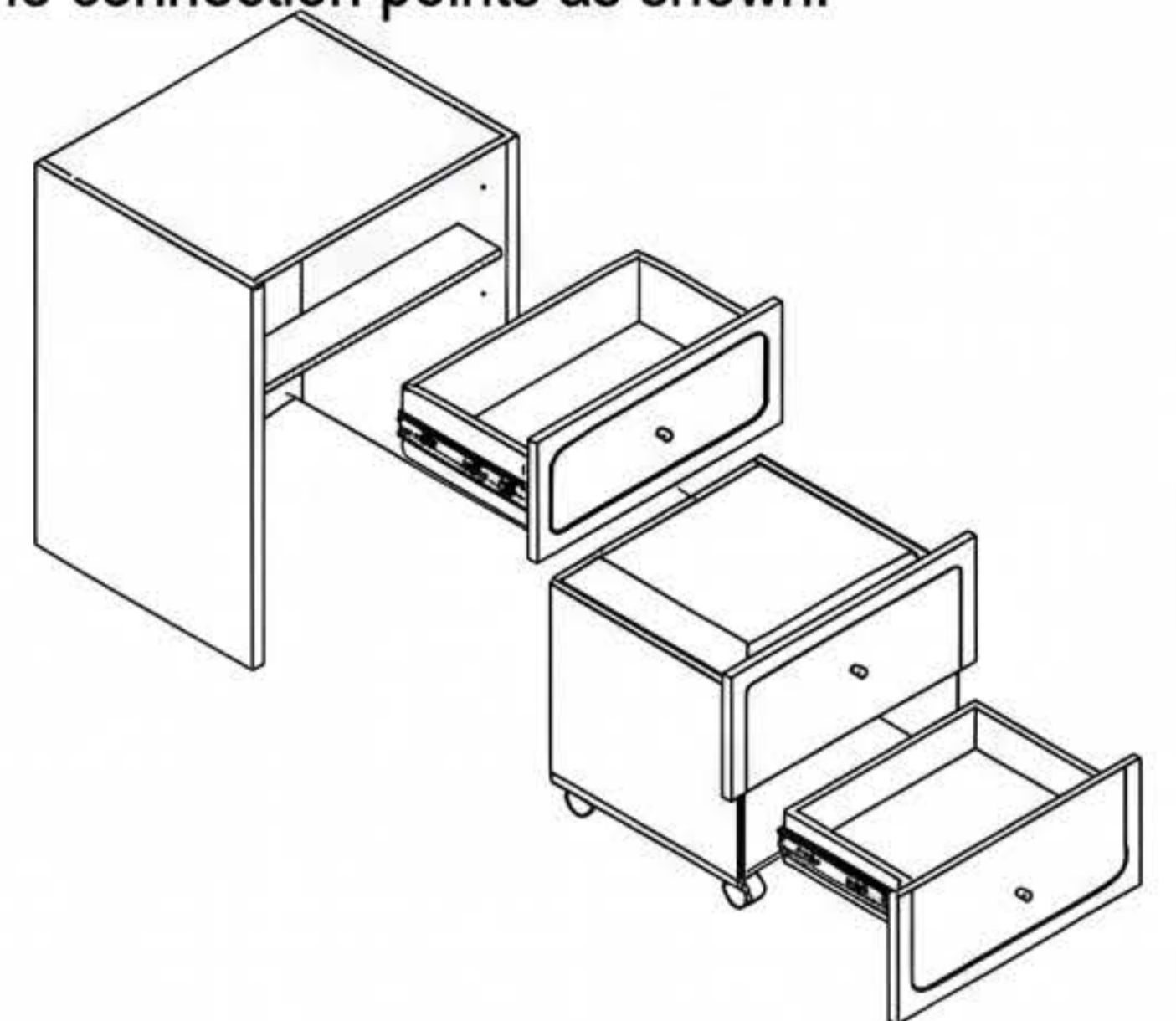

Step 7: Locate panels 35, 36, 37, 38 and assemble as shown below.

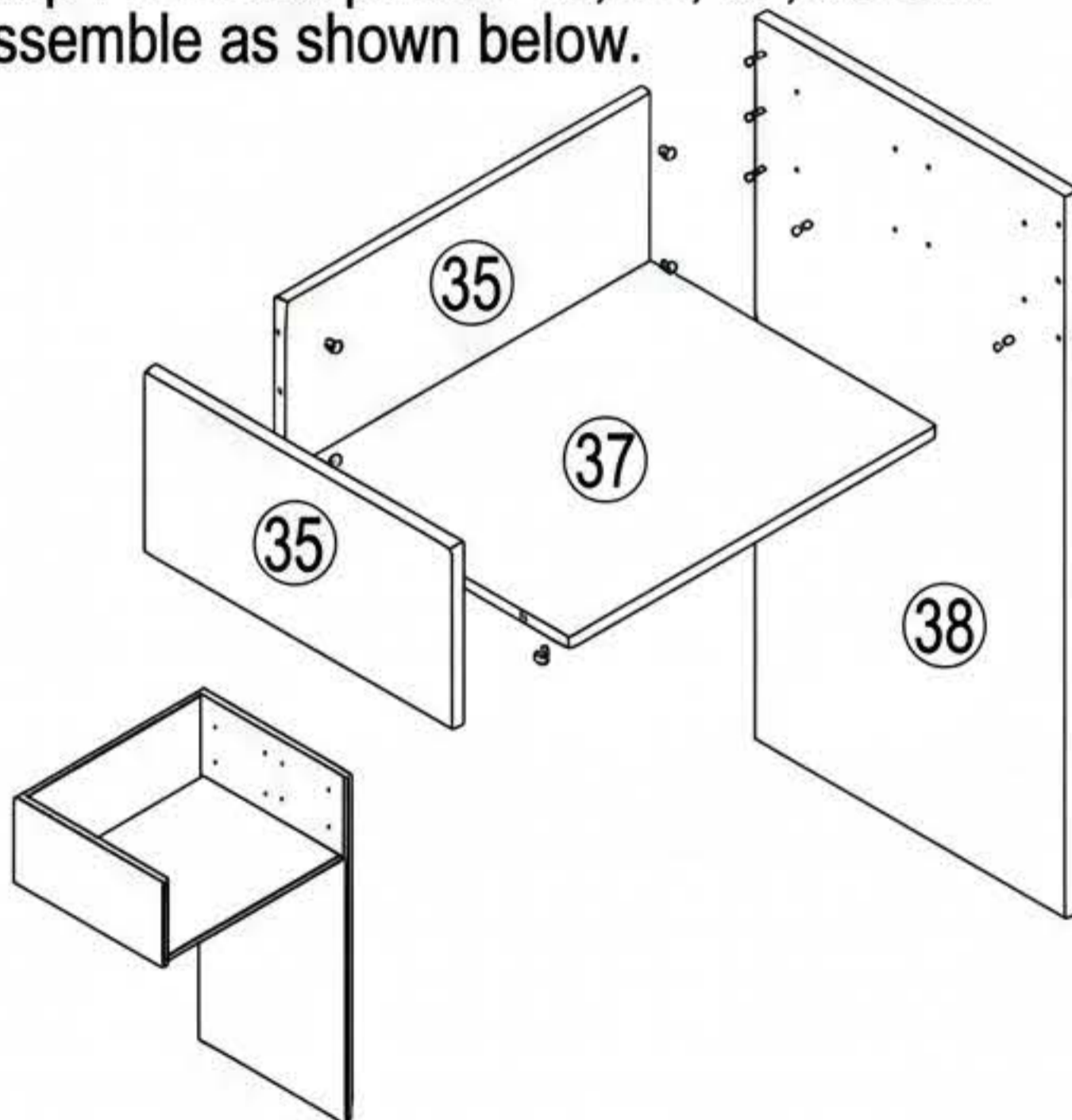

Step 8: Install the two smaller drawers (from Step 2) using the pre-installed drawer slides.

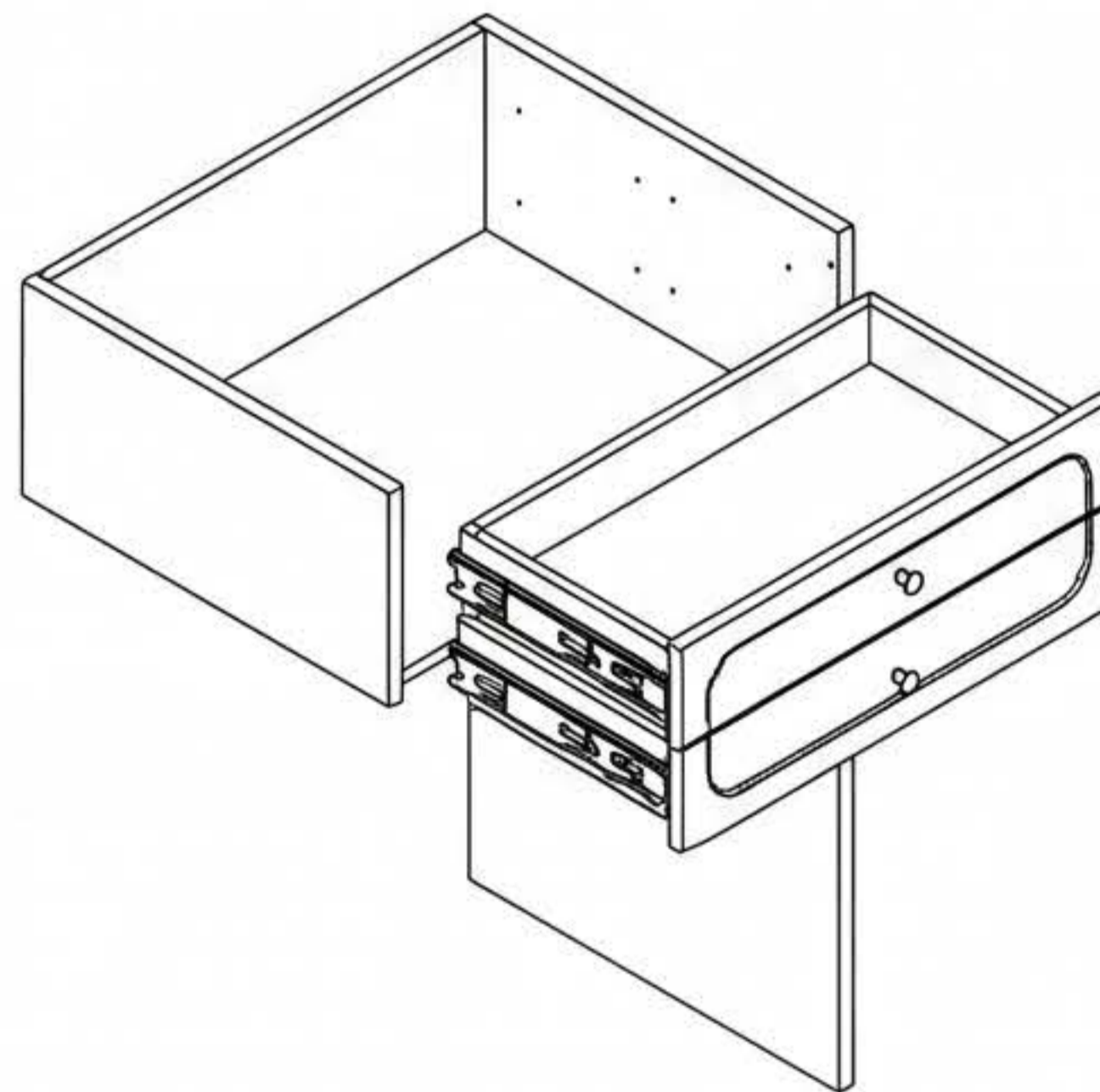

Step 9: Locate panel 39 and assemble as shown below.

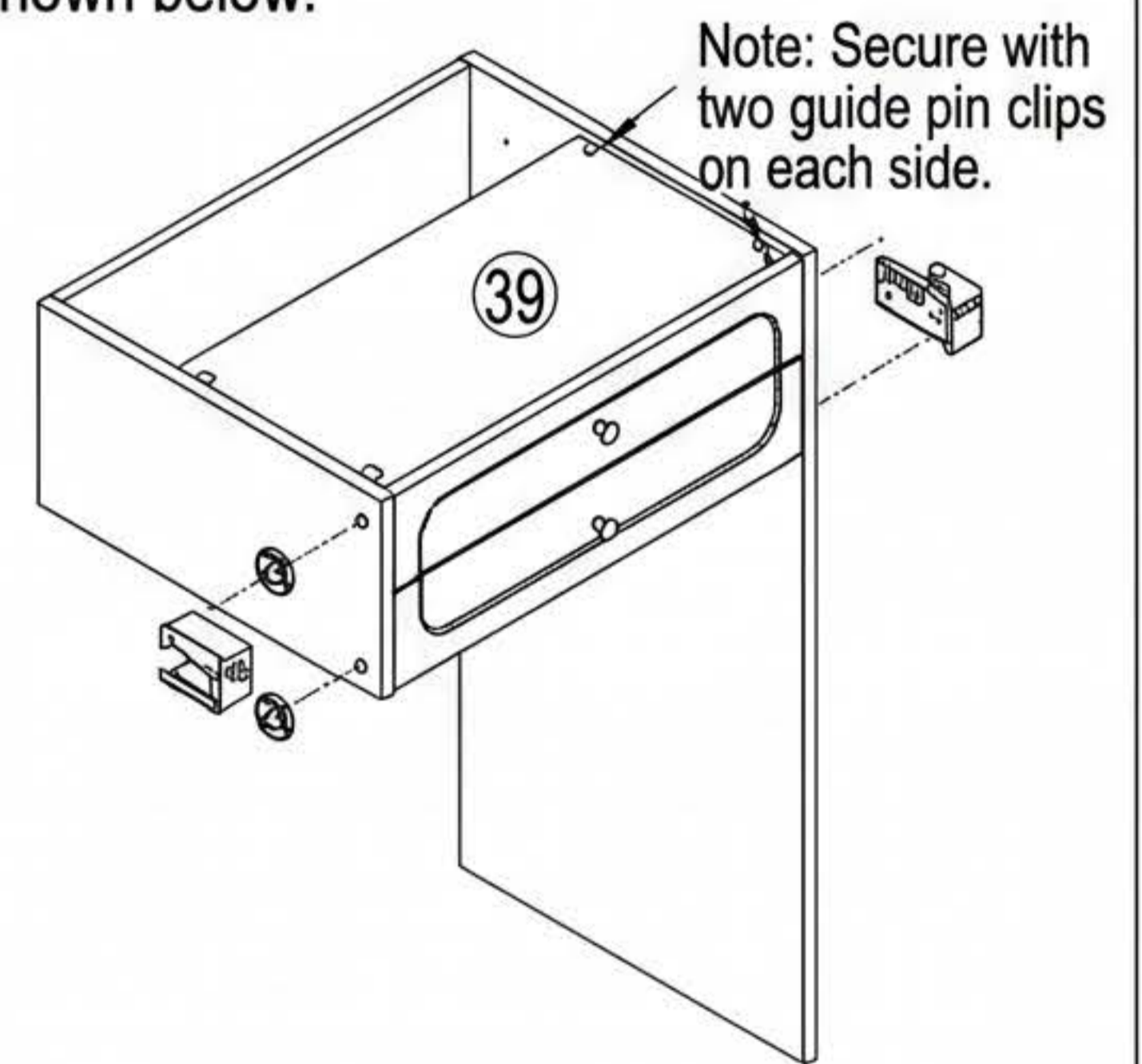

Step 10: Locate panel 40, and secure it using self-tapping screws as shown below.

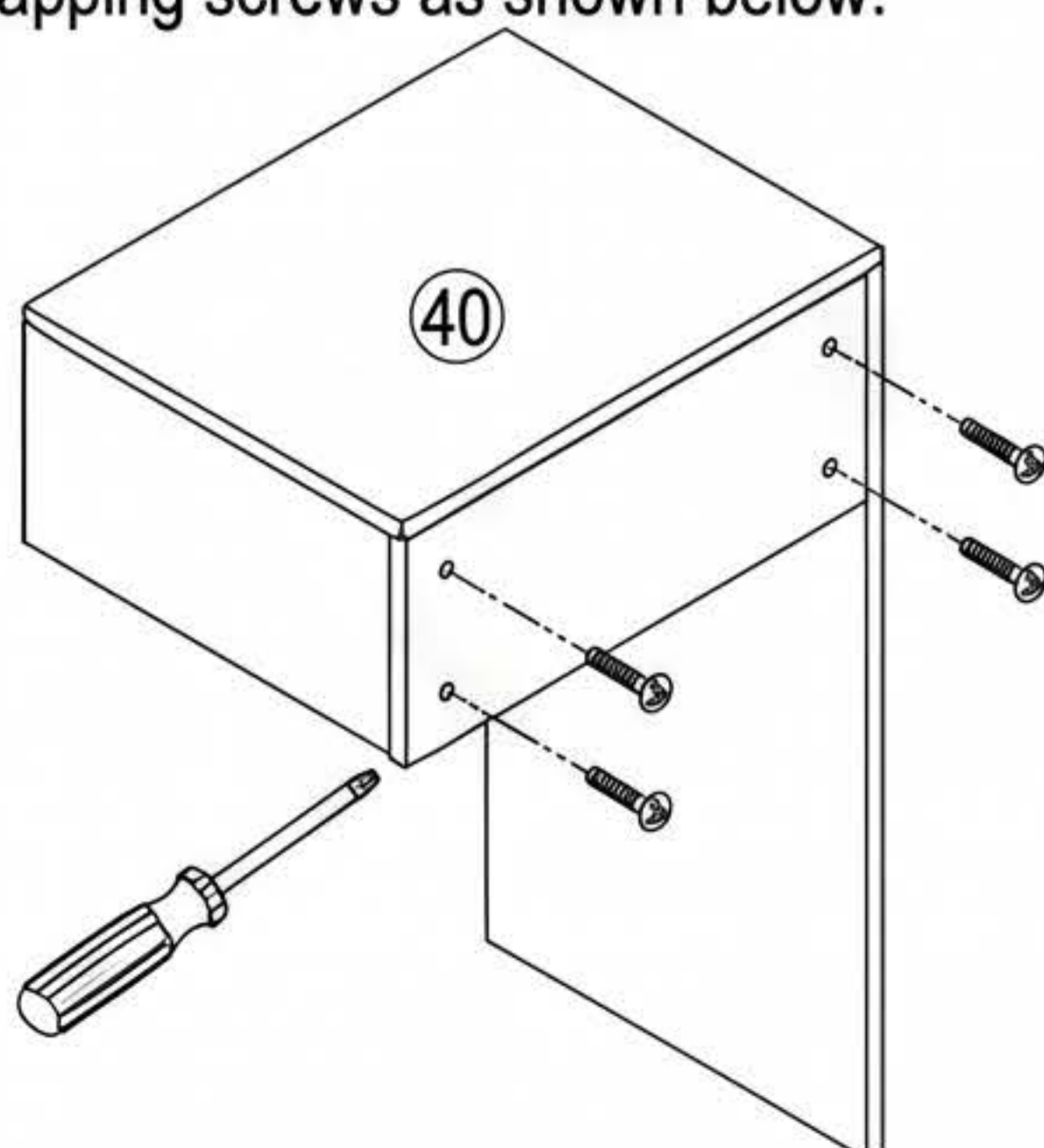

Step 11: Installation complete.

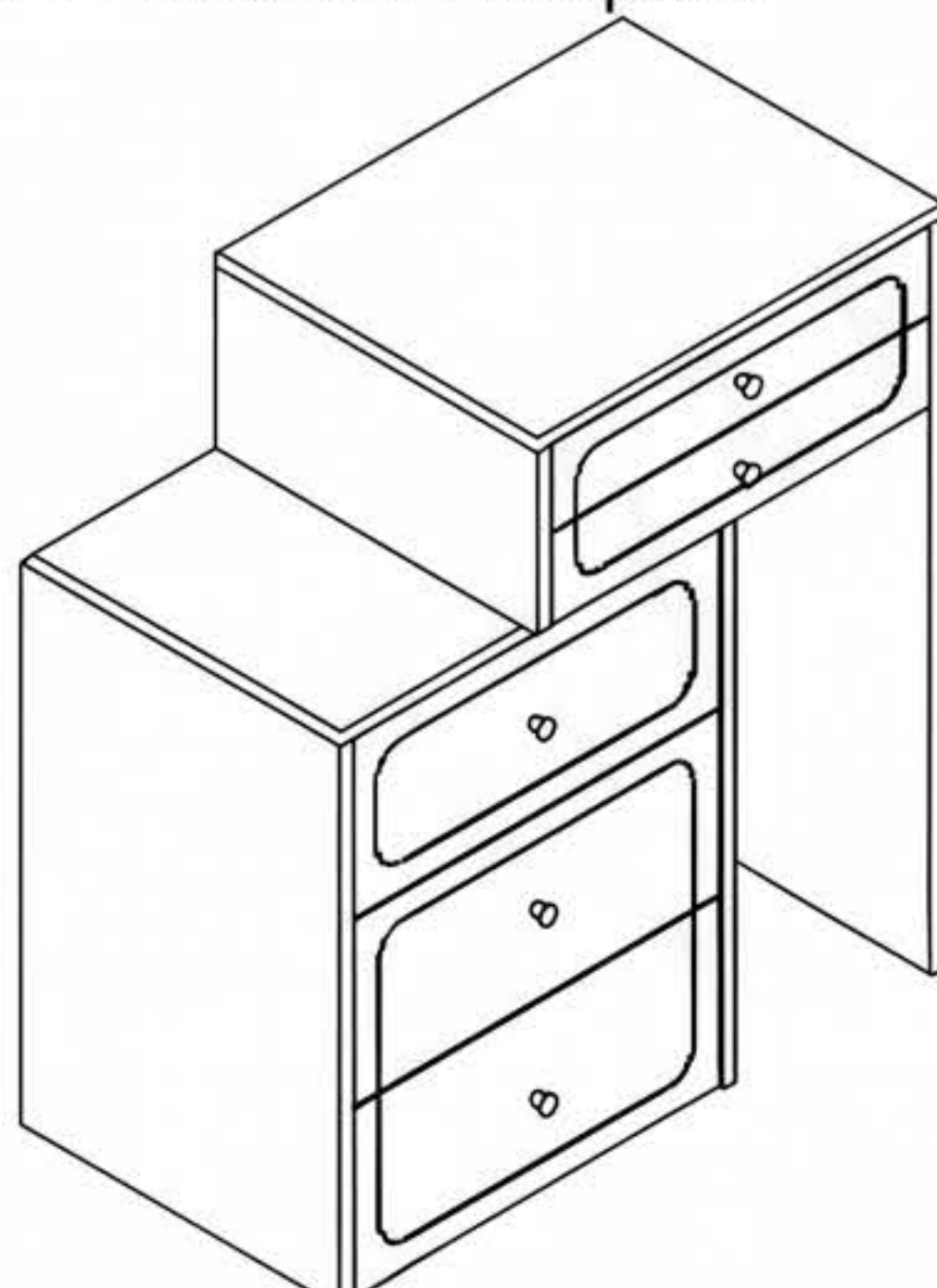

Step 12: Top-down view.

